

**PRESA DI FORZA A
COMANDO PNEUMATICO
PNEUMATIC CLUTCH
POWER TAKE-OFF**

CODICE PTO
PTO CODE

060001

CAMBIO
GEARBOX

**SHAANXI
FAST G**

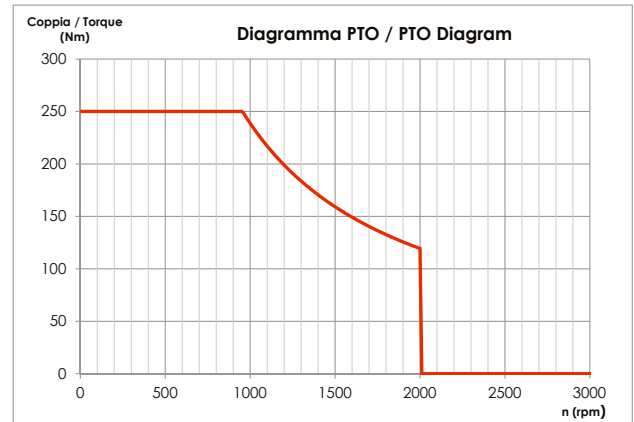
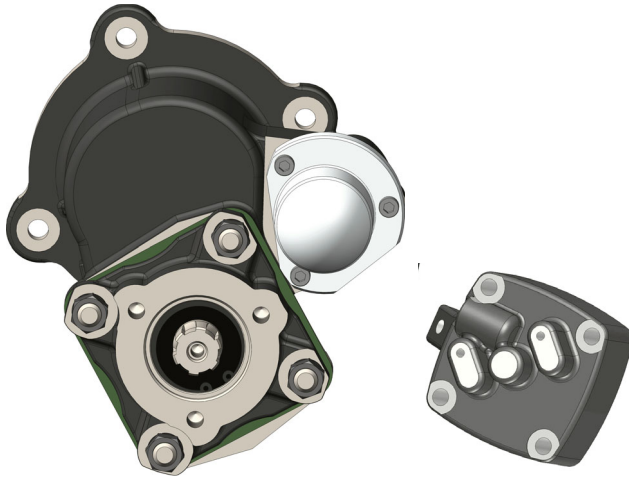

Technical drawings showing dimensions: 147, 4.1, 120, 130.3, 13, 98.4, 102.4, 106.7, 102.4, 81.05, 4xØ10.5, Ø145, 3xM10, Ø72, 81.05, 130.3, 13, 98.4, 102.4, 106.7, 102.4, 4xØ10.5, Ø145, 81.05, 130.3, 13.

Albero/Shaft
6x21x25
(150 14)

**Gruppo cilindro per
messa a folle.**
Clutch inhibitor assembly

Technical drawing showing dimensions: 117, 59.5, 59.5, 95, 115, 0.4, 65.

Codice/Code
50002200021

**Già compreso nel codice
PTO. Solo per ricambi.**
*Already included in PTO code.
Spare parts only.*

Tipo cambio Gearbox	Codice PTO PTO code	Versione Version	Giri pto a 1000 giri motore Pto ratio@1000 eng.rpm rpm	Coppia massima Max torque Nm	Lato montaggio Mounting side	Uscita Output Output	Rotazione Rotation Rotation	Kit di montaggio Mounting kit	Peso Weight kg
12 JS-160T 12 JS-200T/TA	06000100137	13	Vedi indice See index	250	Post. Rear	Post. Rear	Antior. Acw	15400305122	11,2



N.B.: PTO adatta solo per cambi sprovvisti di foro di lubrifica.
PTO suitable only for gearboxes without lubrication hole.